

We've got a plan for you.



WINNEBAGO®



Winnebago Minnie Winnie 20RG

When it comes to versatility, maneuverability and affordability, the Winnebago Minnie Winnie shows its true style in comfort and convenience. Sensible floor plans on Chevy and Dodge chassis make the 20, 23 and 24 foot Minnie Winnies nimble road travelers, providing a comfort level specially tailored to your motor home budget.

The tub and shower combination is standard, with the bath up front in the 20 foot version and in the rear in the longer style. Both feature convenience grouped kitchen and dinettes with spacious storage areas and pre-finished washable vinyl paneling in attractive woodgrain for easy maintenance.

The 25-foot Sportman's Den is built for the sportsminded with a variety of floor plan arrangements available.

Our newest addition, the Bunkhouse 24RH, features bunk beds with individual windows and accesses designed for privacy and convenience. Bunkhouse interior options and standard features mirror the thoughtful refinement of the entire Winnebago line.

All of our models feature as standard a 350 cu. in. Chevy or 360 cu. in. Dodge V8 engine, aluminized exhaust system for long life, cab undercoating to fight unwanted corrosion and RV thumpless tires for traveling ease and pleasure.

All four models drive and park with ease... giving a road hugging ride usually reserved



A.

for heavier vehicles. But the agility designed into each Winnebago puts it right at home, even on the roughest back roads.

Wide open floor plans... ample breathing room... full kitchens and baths... extra passage headroom... they all make for a comfort level second to none. Winnebago expert engineering and construction extends to all our vehicles, providing you with the best in safety features including our Thermo-Steel® construction.

Overall Winnebago excellence gives you peace of mind and the added benefit of higher resale value. We offer a strong warranty plan honored across the country by dealers ready to handle any problems you might have.



B.



C.

A. Interior space in the Minnie Winnie 20RG is surprising for a motor home of this size.

B. Sportman's Den C25RB options replace the couch and dinette.

C. Swivel chairs and a folding table are an optional choice to replace the standard couch on the Minnie Winnie 23RB.

Cover photograph: Winnebago

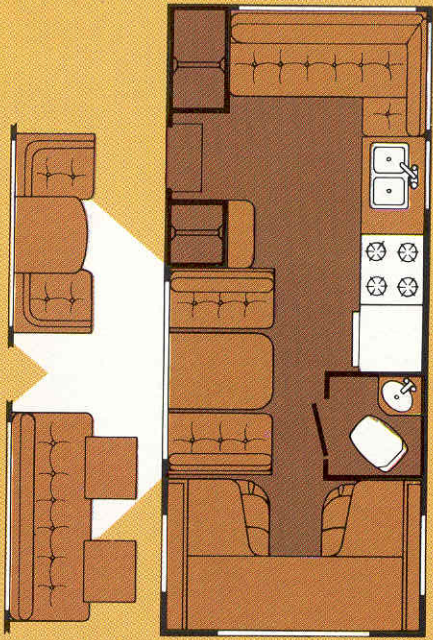

Minnie Winnie 20RG

Dinette standard.
 Convertible couch with two tables to replace dinette.
 Rear pedestal table.
 Lounge chairs and table to replace dinette.

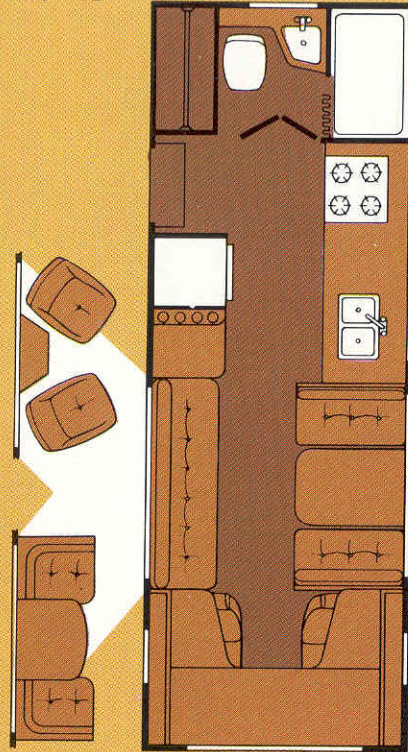

Minnie Winnie 23RB

Convertible couch standard.
 Lounge chairs and table to replace couch.
 Swivel chairs and folding table to replace couch.

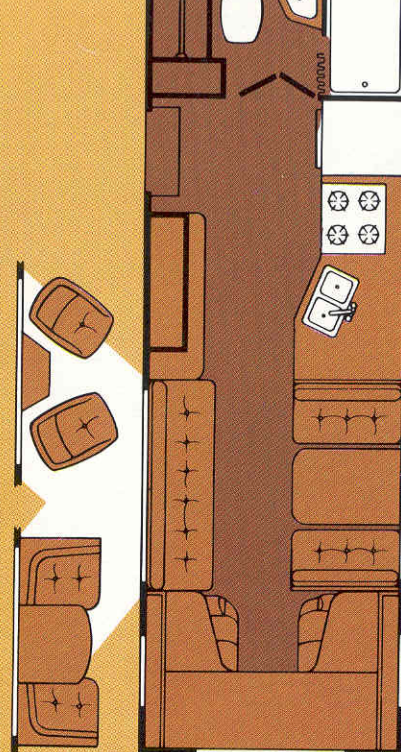

Sportman's Den 25RB

Pull-out couch with two pedestal tables to replace dinette.
 Lounge chairs and table to replace couch.
 Swivel chairs and folding table to replace couch.

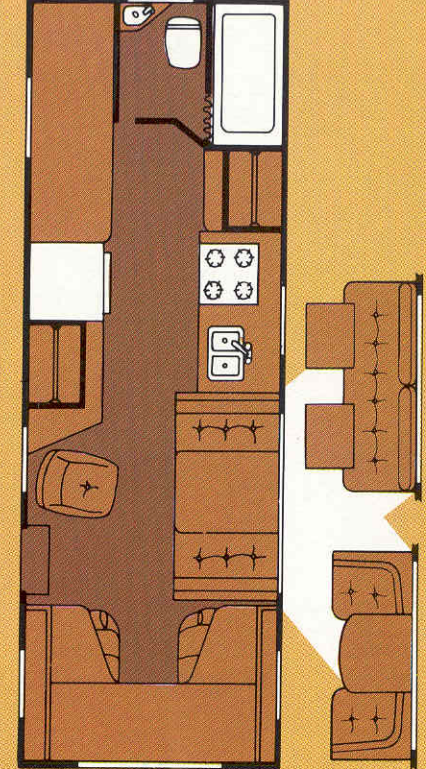

Bunkhouse 24RH

Dinette Standard.
 Lounge chairs and table to replace dinette.
 Convertible couch with two tables to replace dinette.

Specifications

MODELS

	MW24RH	SD25RB	MW20RG	MW23RB
Length:	24'	24'8"	20'5"	22'11"
Wheelbase:	163"	157"	127"	145"
Int. width:	90½"	89½"	89½"	89½"
Height:	111"	112"	111"	111"
Height, int.:	80"	77½"	80"	80"
GVWR (lbs.):	11,500	11,000	9,000*	10,500
V8 engine (cu. in.):	360	350	360	360
Batteries (Amp):	70	70	70	70
Aux. battery (Amp):	105	105	105	105
Fuel capacity (gal.):	35	50	35	35
LPG tanks (lbs.):	42	42	42	42
Fresh water capacity (gal.):	66	60	32	32
Sleeping capacity: Std.	5	5	5	5
Opt.	4	5	5	5
Refrigerator (cu. ft.):	6	8	6	6
Water heater (gal.):	6	6	6	6
Furnace (BTU):	22,000	22,000	19,000	19,000
Holding tank capacity (gal.): Main	35	35	16	21
Aux.	21	21	23	8

*Available with 10,500 GVWR chassis at extra cost.

There are a lot of reasons why you'll sleep better in a Winnebago

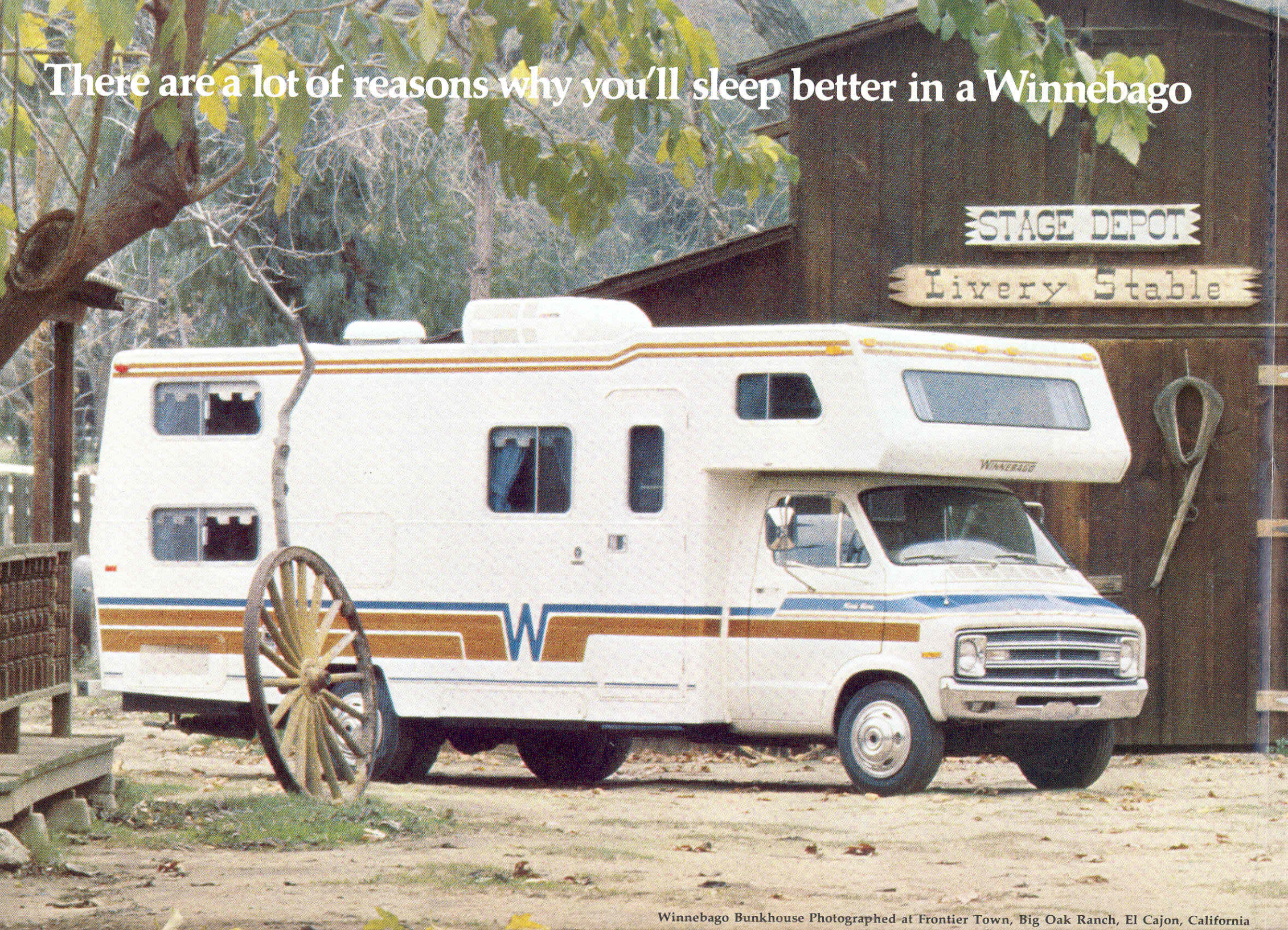



The Bunkhouse offers spacious living with western flair.



Bunk beds with individual windows give buckaroos a private look at the outside world.

Additional Standard Features.

Driver's compartment: ■ Ashtray ■ Cigarette lighter ■ Inside rearview mirror ■ AM radio with four 10-oz. speakers ■ Two sunvisors ■ Tilt steering wheel (Sportman's Den) ■ Trash container (Sportman's Den).

Chassis: ■ Chrome front bumper with rear painted bumper incorporating sewer hose storage (Minnie Winnie) ■ RV thumpless tires ■ Spare wheel and carrier ■ Jack and tools ■ Cab undercoating (Sportman's Den).

Appliances: ■ Forced air furnace with decorative grille ■ Four burner range with fashionable black oven ■ Three-way gas/electric refrigerator

■ Non-power bath vent ■ Non-power stove vent ■ Three-way gas/electric refrigerator with double door on Sportman's Den ■ Power bath vent ■ Power stove vent.

Bath: ■ Carpeting (except MW20RG) ■ Color coordinated lavatory, shower-tub combination, and marine toilet ■ Lighted mirror (Sportman's Den) ■ Mirror (Minnie Winnie) ■ Shower curtain and track ■ Flexible head shower ■ Solid bath door ■ Tissue holder ■ Towel bar/door stiffener.

Kitchen: ■ Double stainless steel sink with cover ■ Brick backsplash ■

Galley extension (MW20RG) ■ Trash container or allotted space (MW20RG).

Sleeping and Lounging: ■ Full size front overhead fold-out bunk and hampers ■ Dinette that converts to bed ■ Rear pull-out bed (20RG).

Convenience: ■ Inside assist straps (Sportman's Den) ■ Screen door ■ Sprung overhead door hinges and positive cabinet latches ■ Front bunk curtain.

Exterior: ■ Lockable water and gas fills ■ Two rearview mirrors ■ Sewer hose and storage ■ 2" sidewall construction ■ Tinted windows ■

Retractable entrance step ■ Steel reinforced floor (Minnie Winnie) ■ Sidewall construction (Sportman's Den) 1" with interior steel reinforcement.

Electrical: ■ Deep cycle battery ■ Battery charger converter.

Utility and Safety: ■ Demand water system ■ Permanent frame-mounted LPG system with gauge and leak sensor ■ Fire extinguisher (2 B.C.).

Minnie Winnie options for the plan of your choice

	MW24RH	MW20RG 9,000 GVWR Chassis	MW20RG 10,500 GVWR Chassis	MW23RB	SD25RB
Automotive air cond.	O	O	O	O	O
440 V8 engine	O	NA	O	O	NA
Cruise control	O	O	O	O	O
Armrests, headrests	O	O	O	O	S
Battery voltage & vacuum gauges	O	O	O	O	O
AM/FM multiplex radio with 8-Track	O	O	O	O	O
40-channel CB radio with antenna*	O	O	O	O	O
California emissions	O	O	O	O	O
Spare tire & cover	O	O	O	O	O
Class I trailer hitch	O	†	O	O	O
Wheel covers	O	NA	NA	NA	S
Beverage tray	O	O	O	O	S
Bath & galley package (Includes medicine cabinet, power bath & stove vents)	S	O	O	S	S
22,000 BTU forced air furnace with electronic ignition	S	O	O	O	S
28,000 BTU forced air furnace with electronic ignition	O	O	O	O	O
8 cu. ft. 3-way gas/electric refrigerator with double door	O	NA	NA	O	S

†With 9,000 GVWR chassis only two of the three options are available on the same unit because of weight factor.

*Not available in Canada

	MW24RH	MW20RG 9,000 GVWR Chassis	MW20RG 10,500 GVWR Chassis	MW23RB	SD25RB
Black-out curtain	O	O	O	O	NA
Luggage rack & ladder	O	†	O	O	O
TV antenna with jack	O	O	O	O	O
11,000 BTU roof air cond.	O	†	O	O	O
13,500 BTU roof air cond.	O	NA	NA	NA	O
Second 105 Amp deep cycle battery	O	NA	NA	NA	O
Generator prep kit (Includes louvered door, steel tray, insulation, wiring & gas line)	O	NA	O	O	O
3,000 watt generator with hourmeter	NA	NA	O	O	NA
4,000 watt generator with hourmeter	O	NA	NA	NA	O
Roof air heating element (with 13,500 BTU only)	O	NA	NA	NA	O
Monitor panel for holding tank & water levels	O	O	O	O	O
83 lb. permanent frame-mounted LPG system	O	NA	NA	O	O
Vinyl floor covering	O	O	O	O	NA
Microwave oven	NA	NA	NA	NA	O
Sportman's package: (equips your Sportman's Den with gun rack and locking shell drawer, fishing rod cabinet, game table, oak parquet entrance, weather gauge and Sportman's exterior graphics)	NA	NA	NA	NA	O

WINNEBAGO®

Winnebago Industries, Inc.
P.O. Box 152 Forest City, Iowa 50436

Winnebago's continuing program of product improvement makes specifications, equipment, model availability and prices subject to change without notice. Some items shown may be extra cost options.